

RABALUX

71335

Item Nr	F (m3/min)	P (W)	SV ((m3/min)/W)	Psb (W)	LWA (dB(A))	c (m/sec)	§
71335	37.41	12.48W	3	0.47	52.92dB	2.06	(EU) 206/2012 EN IEC 60879:2019 INFO: WWW.RABALUX.COM

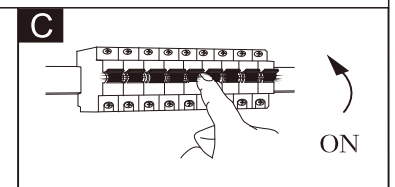
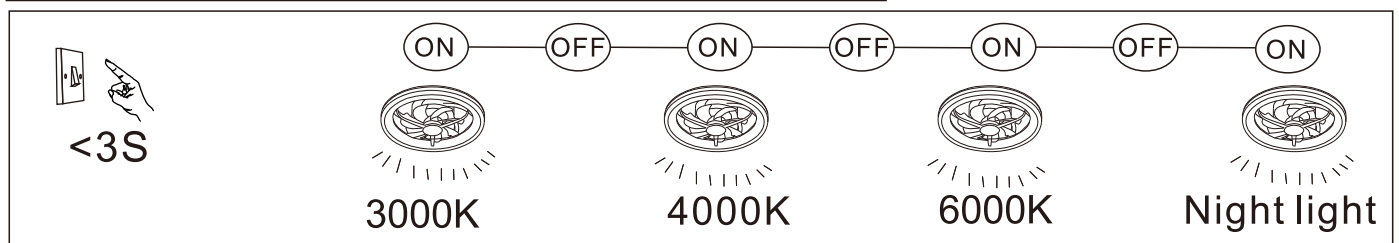
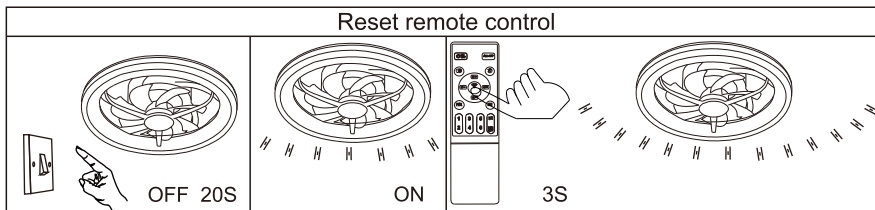
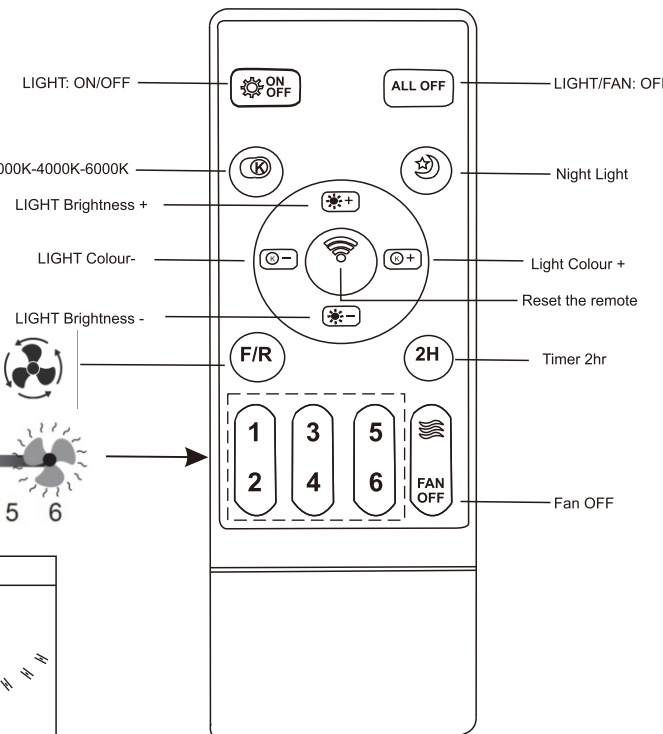
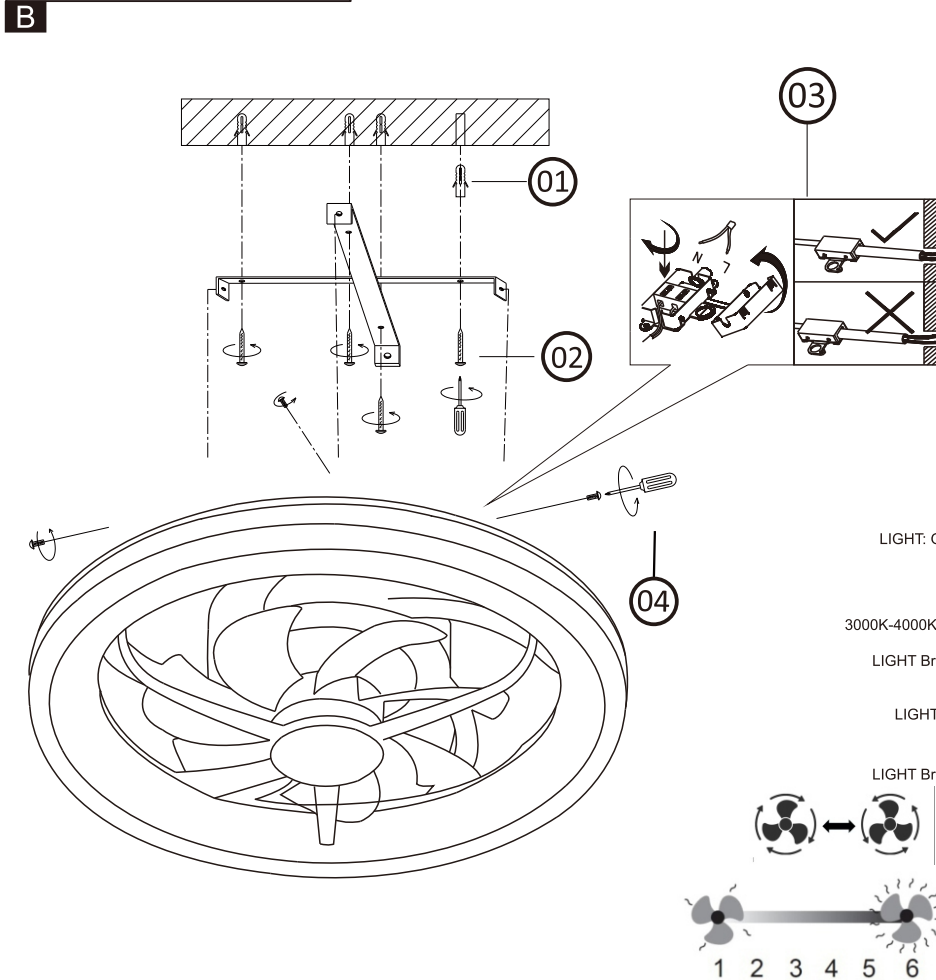
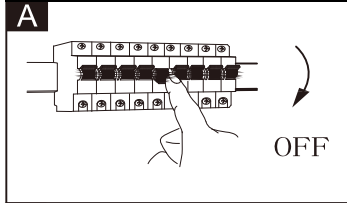

SET UP

- Connect the mobile phone to the Wi-Fi network(2.4GHz band).
- Scan the QR code and download the APP

RESET REMOTE CONTROL

(Skip this step if the remote control works correctly)

- Turn the lamp off for at least 20 seconds; then turn it on and press the bottom“”on the remote control

If the lamp starts blinking, the remote control is reset successfully

LAMP CONNECTION

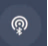
- (1) Access the APP and click the symbol “+” under of the screen.
- (2) Please enter the device name, like living room, and then confirm
- (3) Enter the “living room” and turn off the lighting at least 20 seconds, after that turn on the lighting , within 5s  hold the bottom, the light will start blinking quickly , that means the lamp connect with mobile phone successfully.
- (4) Or follow the instruction on the screen as photo show



①

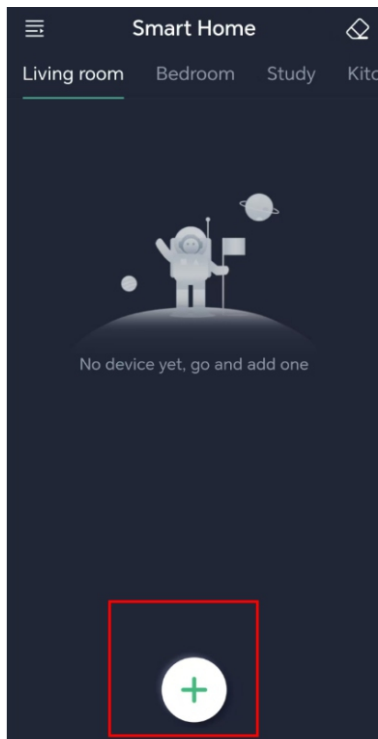

②

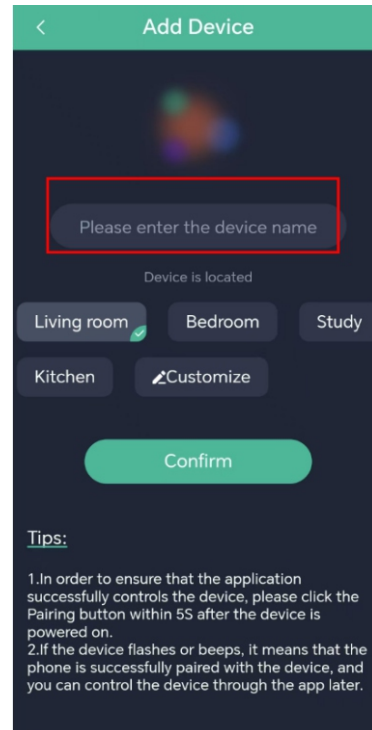

③

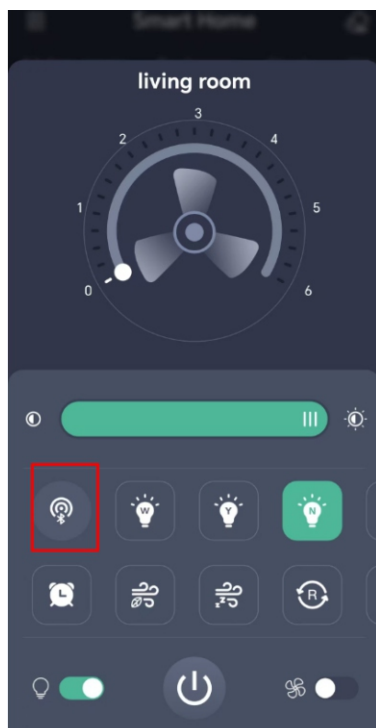

④

